

# Emergency escape lighting Version „KAPPA“



## Emergency escape lighting Version „KAPPA“

**Surface mounted lamp  
Single battery system**

**Luminous intensity distribution:**

**Escape route lighting**

### Specification

Version	KAPPA
Light distribution	Asymmetric (Please ask for: Isolux diagram / EULUMDAT-data)
Mounting	Surface mounted
Light source	2 x 3 W LED
Power	10 VA
Battery	NiMH 3,6 V / 2500 mAh, service life rating 3,0 h
Ambient temperature	-10 °C - +40 °C
IP class	IP 40
Protection class	I
Housing	Steel sheet coloured, standard colour RAL 9010 (white)
LED-Panel	Steel sheet coloured, standard colour RAL 9005 (black)
Weight	ca. 1,6 kg
Dimension (l x w x h)	180 mm x 240 mm x 60 mm
Terminal	WAGO Lighting connector 2,5 mm <sup>2</sup>

### Order information

	Standard colour RAL 9010	Special colour : Y = RAL colour
<b>Single battery system Lamp self-contained</b>	<b>752210 – KP/E/A/Z/DA/S</b>	<b>752220 – KP/E/A/Y/DA/S/RAL</b>
<b>Single battery system Lamp with 2 wire bus system</b>	<b>752230 – KP/E/A/Z/DA/C</b>	<b>752240 – KP/E/A/Y/DA/C/RAL</b>

## Dimension

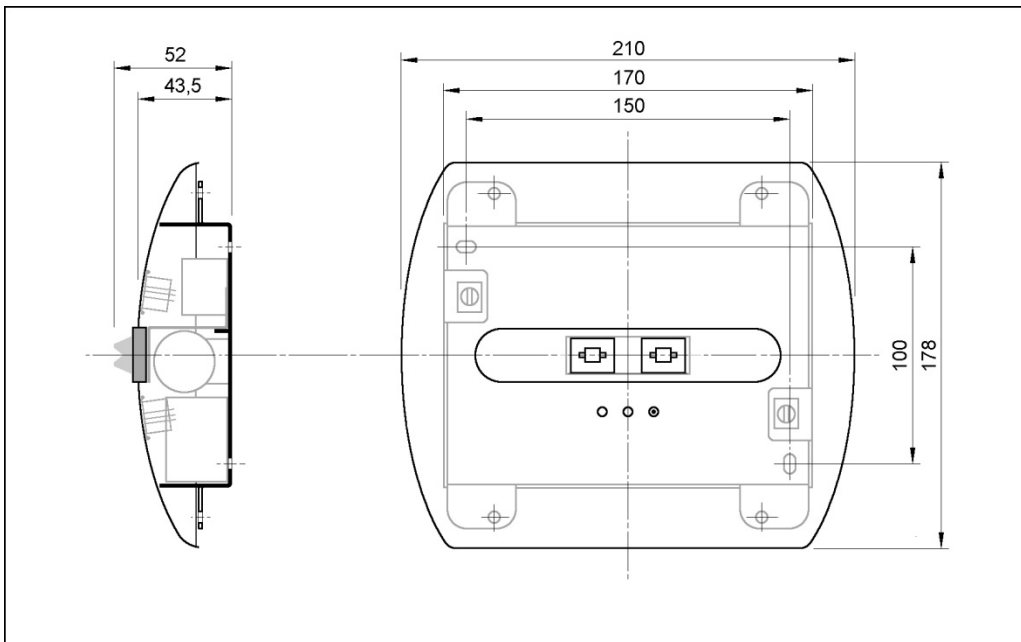

## Display mode - Indicator LED

Handling push button	Mode of indicator LED	Meaning	Troubleshooting
	Green LED on	Charging function is running	
	Green LED off	No charge (battery is missing)	→Connect battery
Keep push button pressed until green LED flashes (longer interval)	Green LED flashes ( longer interval)	Verify function – functional test is running	
Keep push button pressed until green LED flashes (short interval)	Green LED flashes ( short interval)	Verify function – capacity test is running	
Keep push button pressed at capacity test	Green LED flashes ( short interval)	Stop capacity test	
	Green LED short flashes	Status check of monitoring system is running	
	Red LED on	Defect of lighting source	→Exchange defect lighting source (LED)
	Red LED off	No fault	
	Red LED flashes ( longer interval)	Battery defect	→ Charge battery for 14 h at least or exchange battery
	Red LED flashes ( short interval)	Battery test is required after 1 year	→ Press push button until green LED flashes (short interval)

## Installation

See document „Installation instruction Emergency escape lighting version KAPPA surface mounted“

### Forchheim und Willing GmbH

Südstraße 21  
09221 Neukirchen / Erzgebirge - Germany

Phone: 0049 371 27816-0  
Fax: 0049 371 27816-29  
E-Mail: info@forchheim-willing.de  
Internet: www.forchheim-willing.de